

## Repair solution for the water pump gasket

**B07.530 | BMW**

Elring offers a repair solution for the water pump gasket for BMW engines B46 B20 B, B48 B20 A/B and B48 B16 A. This avoids having to replace the entire water pump.

The old gasket is first removed using a suitable tool. Before installation, make sure that the surface is clean and free from residue. Sealing compound points (see Figure no. 2) must be applied to ensure that the gasket remains in the correct place during installation. To ensure that the EPDM gasket functions perfectly, you should wait 30 minutes after installation.

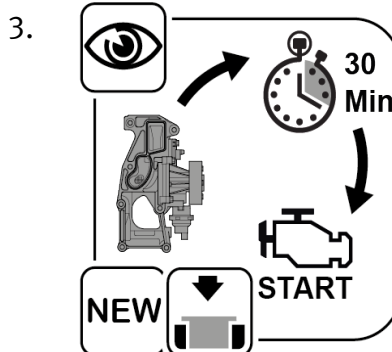
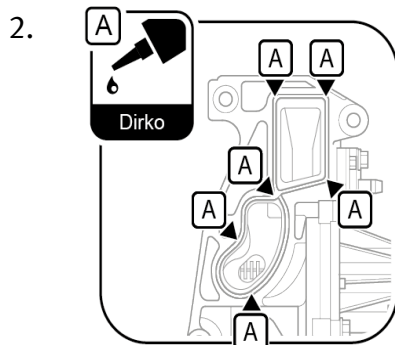
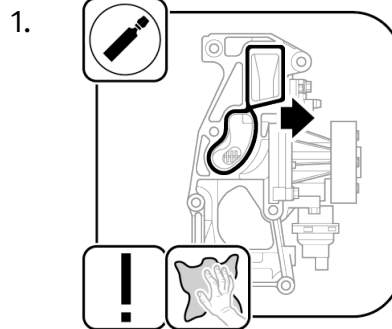

**ElringKlinger AG | Aftermarket Division**

Max-Eyth-Straße 2 | D-72581 Dettingen/Erms

Fon +49 7123 724-799 | Fax +49 7123 724-798

service@elring.de | www.elring.com

SI 02/2024



**Das Original**